

Addendum No. 1

January 17, 2026

RVS Drainage Improvements Project Tulsa Airports Improvement Trust Project No. 70721

This addendum is hereby made a part of the project documents to the same extent as though it were originally included therein. The following changes, modifications, corrections, clarifications, additions, and/or deletions as set forth herein shall apply to the above-referenced proposal package and shall be made apart hereof and be subject to all of the requirements as though originally specified and/or shown. **The bidder shall acknowledge receipt of this addendum in the appropriate blank of the bid form.**

This Addendum is issued to provide the following information/clarification:

Attachments:

1. Attachment No. 1 – Revised Bid Documents Project Manual Exhibit A Bid Form Page 1
2. Attachment No. 2 – Add to Bid Documents Project Manual Exhibit B Davis Beacon General Decision Construction Type; Heavy
3. Attachment No. 3 – Revised Issued For Bid Plans
Replaced Dwg Sheet 53 of 53
Revised Dwg Sheet 21 of 53
Revised Dwg Sheet 24 of 53
Revised Dwg Sheet 29 of 53
Revised Dwg Sheet 35 of 53
4. Attachment No. 4 – Question and Clarification Log Revision 0

ITEM 1 - Public Bid Opening

– Public Bid Opening Schedule Change

PLEASE NOTE - The subject project -Public Bid Opening - will be rescheduled to Wednesday January 28, 2026 at 1:00pm.

ITEM 2 – Questions and Clarifications Log

– Questions and Clarifications Requests

PLEASE NOTE - Requests will be accepted up to Wednesday January 21, 2026 at 1:00pm

ITEM 3 – Bid Documents - Project Manual

Exhibit A - Bid Form/ Bid Tabulation

- Revised Bid Form Page 1 of the of Bid Documents Exhibit A

PLEASE NOTE — This revised Bid Form Page 1 is provided here as **ATTACHMENT NO. 1** and must be completed and submitted with the contractors Bid Package. This revised Bid From page 1 has been adjusted to align with the Bid Documents.

Calendar Contract Days 85

ITEM 4 – Bid Documents - Project Manual

Exhibit B – Wage Determination

- Revised the Bid Documents Exhibit B by adding the Davis Beacon General Decision Number OK20250017 1/3/2025 construction Type: Heavy and is provided here as **ATTACHMENT NO. 2**.

PLEASE NOTE — Davis Beacon prevailing wage rates will be required and monitored on this Federally Funded Project

ITEM 5 – Bid Documents – Issued for Bid Plans

- Revised the Issue for Bid Plans by replacing Drawing Sheet 53 of 53 and revising Drawing Sheets 21, 24, 29, and 35 of 53.

PLEASE NOTE — Revised Issue for Bid Plans are provided here as **ATTACHMENT NO. 3**.

ITEM 6 – Question and Clarification Log

PLEASE NOTE — The Question and Clarification Log Revision 0 is provided here as ATTACHMENT NO. 4.

End of Addendum No. 1

To:

Tulsa Airports Improvement Trust
7777 Airport Drive, Suite A211
Tulsa, Ok. 74115

From:

Firm Name: _____

Address: _____

City, State, Zip: _____

Telephone: _____

EIN / TIN Number _____

Email Address: _____

List Addendum Numbers Received:

_____, _____, _____, _____, _____, _____,
_____, _____, _____, _____, _____, _____,
_____, _____, _____, _____, _____, _____.

RE: RVS Drainage Improvements, TAIT Project 70721

Bid Date: 1/28/2026

The undersigned, being familiar with the local conditions affecting the cost of the work, the Solicitation for Bids and the Contract Documents, and the Schedule of Quantities, and being fully cognizant of the difficulties to be encountered with the provisions thereof, hereby proposes to furnish all labor, materials and equipment necessary for the sums listed herein, **FOR THE UNIT PRICE AMOUNT OF:**

BASE BID: _____ (United States Dollars).

In submitting the bid, it is understood that the Owner has the right to reject any and all bids, and it is agreed that this bid may not be withdrawn for a period of thirty (30) days after the Bid Date set out above. Work must start within ten (10) days after receipt of Notice to Proceed, unless another date is agreed to by the Owner and Contractor. The amount of work to be included in the project awarded will be based on the amount of funding that is available at the time of Contract(s) award.

The evaluation of bids will be conducted in accordance with the Oklahoma Public Competitive Bidding Act of 1974, Okla. Stat. tit. 61, §101 et seq. (2025). The Contractor will be expected to complete the project based on the Contract Days set out below.

The undersigned bidder agrees to complete all of the construction work included in the contract in accordance with the Contract Documents after a Notice to Proceed is issued, and agrees that liquidated damages shall be deducted from the final payment due the Contractor pursuant to the terms and conditions of the Contract Documents.

Calendar Contract Days: 85

ADDENDUM 1 Attachment 2

EXHIBIT B Highway

"General Decision Number: OK20250017 01/03/2025

Superseded General Decision Number: OK20240017

State: Oklahoma

Construction Type: Highway

Counties: Creek, Okmulgee, Osage, Pawnee, Rogers, Tulsa and Wagoner Counties in Oklahoma.

HIGHWAY CONSTRUCTION PROJECTS (excluding tunnels, building structures in rest area projects & railroad construction; bascule, suspension & spandrel arch bridges designed for commercial navigation, bridges involving marine construction; and other major bridges).

Note: Contracts subject to the Davis-Bacon Act are generally required to pay at least the applicable minimum wage rate required under Executive Order 14026 or Executive Order 13658.

Please note that these Executive Orders apply to covered contracts entered into by the federal government that are subject to the Davis-Bacon Act itself, but do not apply to contracts subject only to the Davis-Bacon Related Acts, including those set forth at 29 CFR 5.1(a)(1).

If the contract is entered	. Executive Order 14026
into on or after January 30,	generally applies to the
2022, or the contract is	contract.
renewed or extended (e.g., an	. The contractor must pay

option is exercised) on or	all covered workers at
after January 30, 2022:	least \$17.75 per hour (or
	the applicable wage rate
	listed on this wage
	determination, if it is
	higher) for all hours
	spent performing on the
	contract in 2025.

If the contract was awarded on	. Executive Order 13658
or between January 1, 2015 and	generally applies to the
January 29, 2022, and the	contract.
contract is not renewed or	. The contractor must pay
all	covered workers at least
extended on or after January	\$13.30 per hour (or the
30, 2022:	applicable wage rate
listed	on this wage
determination,	if it is higher) for all
	hours spent performing on
	that contract in 2025.

The applicable Executive Order minimum wage rate will be

adjusted annually. If this contract is covered by one of the Executive Orders and a classification considered necessary for performance of work on the contract does not appear on this wage determination, the contractor must still submit a conformance request.

Additional information on contractor requirements and worker protections under the Executive Orders is available at <http://www.dol.gov/whd/govcontracts>.

Modification Number	Publication Date
0	01/03/2025

SUOK2011-004 04/18/2011

	Rates	Fringes
Traffic signal installer.....	\$ 18.04	
CARPENTER (Includes Form Work, and Curb Line Formsetting)		
Remaining Counties.....	\$ 13.24 **	
Rogers County.....	\$ 14.82 **	
Tulsa County.....	\$ 12.80 **	
CEMENT MASON/CONCRETE FINISHER		
Remaining Counties.....	\$ 13.36 **	
Tulsa County.....	\$ 13.44 **	
IRONWORKER, REINFORCING.....	\$ 15.38 **	
IRONWORKER, STRUCTURAL.....	\$ 14.21 **	
LABORER		
Asphalt Raker and Shoveler		
Remaining Counties.....	\$ 12.40 **	1.57
Rogers County.....	\$ 11.76 **	1.57
Common or General		
Creek County.....	\$ 10.95 **	

Remaining Counties.....	\$ 10.70	**
Rogers County.....	\$ 10.14	**
Tulsa County.....	\$ 10.84	**
Wagoner.....	\$ 10.32	**
Landscape.....	\$ 8.67	**
Pipelayer.....	\$ 12.35	**
Power Tool Operator (Includes Chipping Guns and Handheld Concrete Saws).	\$ 12.89	**
Traffic Control (Includes Flagger, Setting Up and Moving Cones/Barrels)		
Remaining Counties.....	\$ 11.05	**
Tulsa County.....	\$ 10.94	**

POWER EQUIPMENT OPERATOR:

Asphalt Paver Screed.....	\$ 12.96	**
Asphalt Paving Machine.....	\$ 13.95	**
Backhoe/Trackhoe		
Remaining Counties.....	\$ 15.16	**
Rogers County.....	\$ 15.11	**
Tulsa County.....	\$ 15.19	**
Bobcat/Skid Loader.....	\$ 12.24	**
Broom.....	\$ 11.97	**
Bulldozer.....	\$ 14.28	**
Concrete Paving Machine.....	\$ 14.11	**
Concrete Saw.....	\$ 11.94	**
Crane.....	\$ 17.45	**
Distributor Truck.....	\$ 13.34	**
Excavator.....	\$ 14.99	**
Grader/Blade.....	\$ 16.68	**
Loader (Front End).....	\$ 13.81	**
Mechanic.....	\$ 17.46	**
Milling Machine.....	\$ 14.56	**
Mixer.....	\$ 14.43	**
Oiler.....	\$ 15.28	**
Roller (Asphalt).....	\$ 12.79	**
Roller (Dirt Compaction)....	\$ 11.71	**
Scraper.....	\$ 13.34	**
Striping Machine.....	\$ 11.94	**
Tractor/Box Blade.....	\$ 13.67	**
Trencher.....	\$ 13.87	**

2.75

TRUCK DRIVER

Dump Truck.....	\$ 13.97	**	
Flatbed Truck.....	\$ 14.69	**	
Lowboy/Float.....	\$ 13.80	**	
Off the Road Truck.....	\$ 13.40	**	
Pickup Truck.....	\$ 12.32	**	
Tandem Axle/Semi Trailer			
Remaining Counties.....	\$ 16.36	**	
Rogers County.....	\$ 14.01	**	0.31
Tulsa County.....	\$ 18.01		
Water Truck.....	\$ 12.00	**	

 WELDERS - Receive rate prescribed for craft performing
 operation to which welding is incidental.

=====

=====
 ** Workers in this classification may be entitled to a
 higher
 minimum wage under Executive Order 14026 (\$17.75) or 13658
 (\$13.30). Please see the Note at the top of the wage
 determination for more information. Please also note that
 the
 minimum wage requirements of Executive Order 14026 are not
 currently being enforced as to any contract or subcontract
 to
 which the states of Texas, Louisiana, or Mississippi,
 including
 their agencies, are a party.

Note: Executive Order (EO) 13706, Establishing Paid Sick
 Leave
 for Federal Contractors applies to all contracts subject to
 the
 Davis-Bacon Act for which the contract is awarded (and any
 solicitation was issued) on or after January 1, 2017. If
 this
 contract is covered by the EO, the contractor must provide
 employees with 1 hour of paid sick leave for every 30 hours
 they work, up to 56 hours of paid sick leave each year.
 Employees must be permitted to use paid sick leave for
 their

own illness, injury or other health-related needs,
including
preventive care; to assist a family member (or person who
is
like family to the employee) who is ill, injured, or has
other
health-related needs, including preventive care; or for
reasons
resulting from, or to assist a family member (or person who
is
like family to the employee) who is a victim of, domestic
violence, sexual assault, or stalking. Additional
information
on contractor requirements and worker protections under the
EO
is available at
<https://www.dol.gov/agencies/whd/government-contracts>.

Unlisted classifications needed for work not included
within
the scope of the classifications listed may be added after
award only as provided in the labor standards contract
clauses
(29CFR 5.5 (a) (1) (iii)).

The body of each wage determination lists the
classifications
and wage rates that have been found to be prevailing for
the
type(s) of construction and geographic area covered by the
wage
determination. The classifications are listed in
alphabetical
order under rate identifiers indicating whether the
particular
rate is a union rate (current union negotiated rate), a
survey
rate, a weighted union average rate, a state adopted rate,
or a
supplemental classification rate.

Union Rate Identifiers

A four-letter identifier beginning with characters other than "SU", "UAVG", ?SA?, or ?SC? denotes that a union rate was prevailing for that classification in the survey. Example: PLUM0198-005 07/01/2024. PLUM is an identifier of the union whose collectively bargained rate prevailed in the survey for this classification, which in this example would be Plumbers. 0198 indicates the local union number or district council number where applicable, i.e., Plumbers Local 0198. The next number, 005 in the example, is an internal number used in processing the wage determination. The date, 07/01/2024 in the example, is the effective date of the most current negotiated rate.

Union prevailing wage rates are updated to reflect all changes over time that are reported to WHD in the rates in the collective bargaining agreement (CBA) governing the classification.

Union Average Rate Identifiers

The UAVG identifier indicates that no single rate prevailed for those classifications, but that 100% of the data reported for the classifications reflected union rates. EXAMPLE: UAVG-OH-0010 01/01/2024. UAVG indicates that the rate is a weighted union average rate. OH indicates the State of Ohio. The next number, 0010 in the example, is an internal number used in producing the wage determination. The date, 01/01/2024 in the example, indicates the date the wage determination was

updated to reflect the most current union average rate.

A UAVG rate will be updated once a year, usually in January, to reflect a weighted average of the current rates in the collective bargaining agreements on which the rate is based.

Survey Rate Identifiers

The "SU" identifier indicates that either a single non-union rate prevailed (as defined in 29 CFR 1.2) for this classification in the survey or that the rate was derived by computing a weighted average rate based on all the rates reported in the survey for that classification. As a weighted average rate includes all rates reported in the survey, it may include both union and non-union rates. Example: SUFL2022-007 6/27/2024. SU indicates the rate is a single non-union prevailing rate or a weighted average of survey data for that classification. FL indicates the State of Florida. 2022 is the year of the survey on which these classifications and rates are based. The next number, 007 in the example, is an internal number used in producing the wage determination. The date, 6/27/2024 in the example, indicates the survey completion date for the classifications and rates under that identifier.

?SU? wage rates typically remain in effect until a new survey is conducted. However, the Wage and Hour Division (WHD) has the discretion to update such rates under 29 CFR 1.6(c)(1).

State Adopted Rate Identifiers

The ""SA"" identifier indicates that the classifications and prevailing wage rates set by a state (or local) government were adopted under 29 C.F.R 1.3(g)-(h). Example: SAME2023-007 01/03/2024. SA reflects that the rates are state adopted. ME refers to the State of Maine. 2023 is the year during which the state completed the survey on which the listed classifications and rates are based. The next number, 007 in the example, is an internal number used in producing the wage determination. The date, 01/03/2024 in the example, reflects the date on which the classifications and rates under the ?SA? identifier took effect under state law in the state from which the rates were adopted.

WAGE DETERMINATION APPEALS PROCESS

1) Has there been an initial decision in the matter? This can be:

- a) a survey underlying a wage determination
- b) an existing published wage determination
- c) an initial WHD letter setting forth a position on a wage determination matter
- d) an initial conformance (additional classification and rate) determination

On survey related matters, initial contact, including requests for summaries of surveys, should be directed to the WHD Branch of Wage Surveys. Requests can be submitted via email to davisbaconinfo@dol.gov or by mail to:

Branch of Wage Surveys
Wage and Hour Division
U.S. Department of Labor
200 Constitution Avenue, N.W.
Washington, DC 20210

Regarding any other wage determination matter such as conformance decisions, requests for initial decisions should be directed to the WHD Branch of Construction Wage Determinations. Requests can be submitted via email to BCWD-Office@dol.gov or by mail to:

Branch of Construction Wage Determinations
Wage and Hour Division
U.S. Department of Labor
200 Constitution Avenue, N.W.
Washington, DC 20210

2) If an initial decision has been issued, then any interested party (those affected by the action) that disagrees with the decision can request review and reconsideration from the Wage and Hour Administrator (See 29 CFR Part 1.8 and 29 CFR Part 7). Requests for review and reconsideration can be submitted via email to dba.reconsideration@dol.gov or by mail to:

Wage and Hour Administrator
U.S. Department of Labor
200 Constitution Avenue, N.W.
Washington, DC 20210

The request should be accompanied by a full statement of the interested party's position and any information (wage payment data, project description, area practice material, etc.) that

the requestor considers relevant to the issue.

3) If the decision of the Administrator is not favorable,
an
interested party may appeal directly to the Administrative
Review Board (formerly the Wage Appeals Board). Write to:

Administrative Review Board
U.S. Department of Labor
200 Constitution Avenue, N.W.
Washington, DC 20210.

=====
=====

END OF GENERAL DECISION"

[illegible]

DETAILS	
TULSA RIVERSIDE AIRPORT DRAINAGE PROJECT	
TULSA OKLAHOMA	AIR NO. 3 40 0008 042 2025

drawn by: _____
designed by: _____
project no.: _____ 025-0079 _____
date: _____ 12.15.2021 _____

POST SCHEDULE	
USE & SECTION	SIZE (8")
CORNER, END & PULL POSTS TUBULAR ROUND	4" O.D.
LINE POSTS TUBULAR ROUND	2 3/8" O.D.
BRACE RAIL TUBULAR ROUND	1 5/8" O.D.

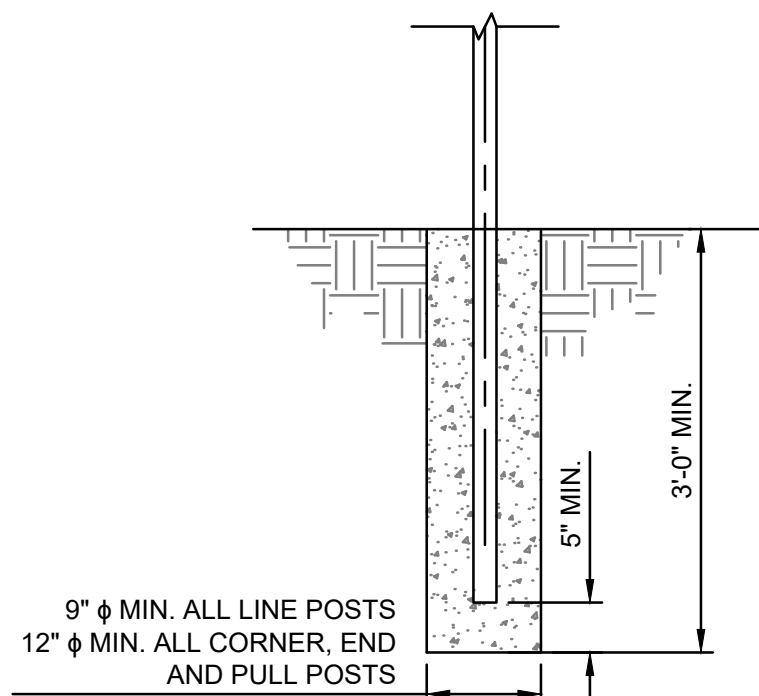

1 6' FENCE CONCRETE POST BASE
SCALE: NOT TO SCALE

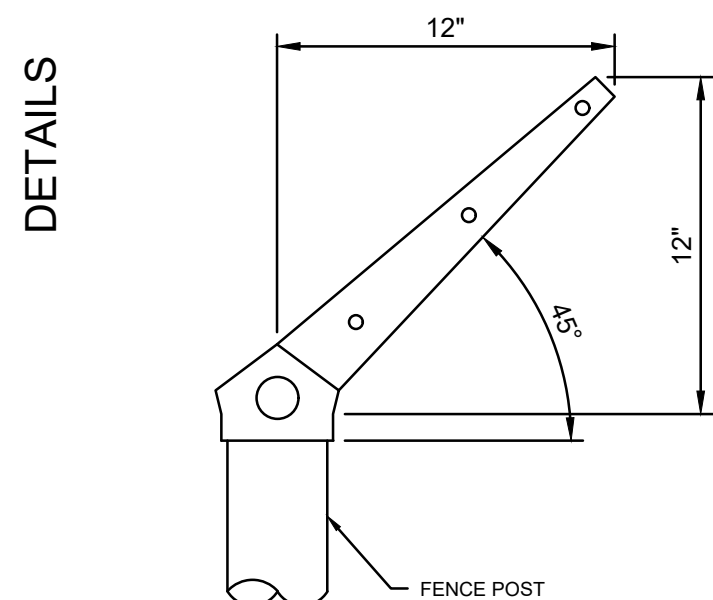

2 PROPOSED BRACKET ARM/TERMINAL DETAIL
SCALE: NOT TO SCALE

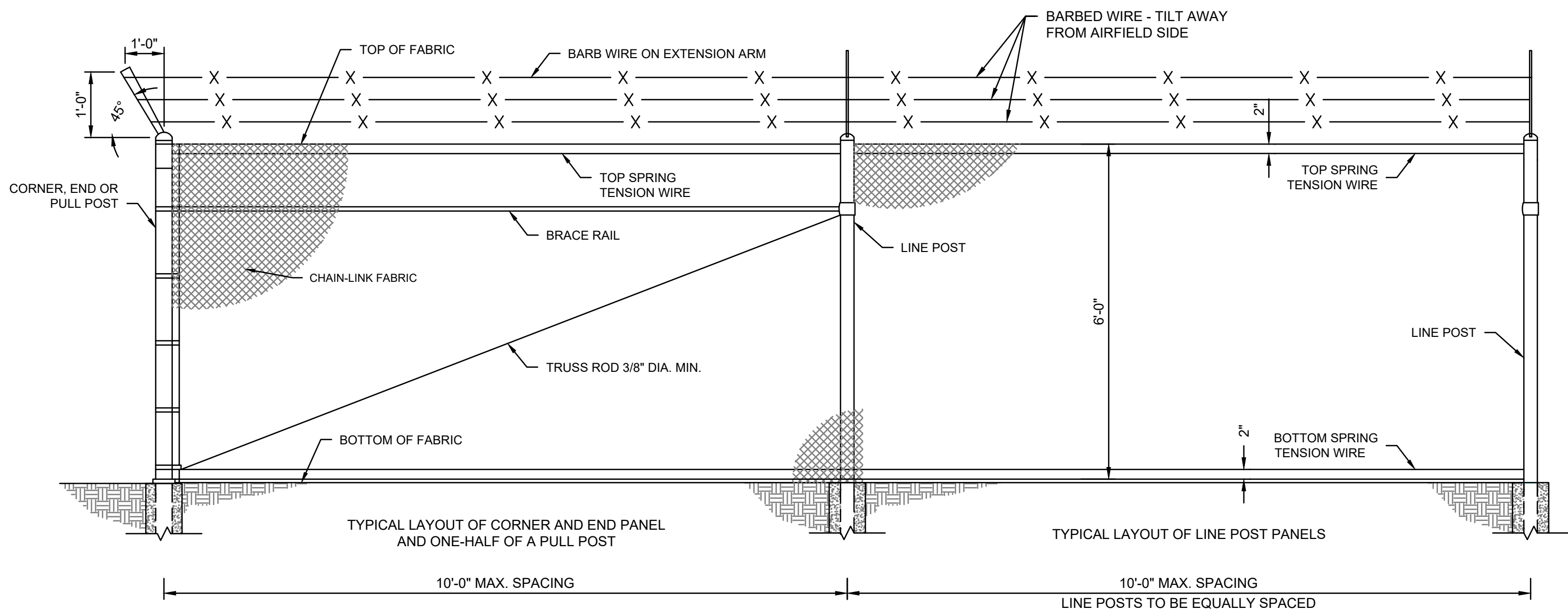

3 6' CHAIN-LINK FENCE DETAIL
SCALE: NOT TO SCALE



7777 Airport Drive, Tulsa, OK 74115
P: 918.838.5000 F: 918.838.5199
www.flytulsa.com



ADDENDUM 1 Attachment No. 4

70721 - RVS Drainage Improvements Project

Bid Questions and Clarifications Log

January 17, 2026 REVISION No. 0

#	Comment From	Question	Response From	Response
1	Magnum Construction	Please clarify the insurance classification for this project – Landside, Airfield, or Terminal Apron	Tom McGann	Landside
2	Magnum Construction	Also Exhibit B shows construction type as Building on wage rates should this be Highway wages?	Tom McGann	Heavy - Tulsa County Oklahoma Davis Beacon Wage Rates added to Exhibit B and is provided as Addendum 1 Attachment 2
3	Chris Redwine	Detailed expectations of the 3 Calendar day for 2B	Brian Coomes	Intent is to limit the closure of the Piper Drive to 3 days in this area.
4	Chris Redwine	Detailed expectations of the 3 Calendar day for 3B	Brain Coomes	Intent is to limit the closure of the Learjet Lane to 3 days in this area.
5	Chris Redwine	Are the contractors responsible the coordination and relocation of the utility pole in conflict with the pilot channel	Hank Amen	Drawings (21,24,29,35) revised ditch location to avoid conflict with utility poleand is provided as Adendum 1 Attachment 3
6	Chris Redwine	Will the contractor be responsible for paying for the coordination with the utility companies and the relocating of the Utilities?	Hank Amen	Yes-TAIT will collaborate with the contractor and the Engineer of Record in accordance with General Provision 40-08 and General Provision 50-16.
7	Ethan Mays - Magnum Construction, Inc	Looking for clarification on sheet 53 - Standard Details. Elevation view is showing woven wire fence with wooden posts. Sheet 16 of 53 calls out 6' Chain Link Fence with Climb Barrier. Sheet 3 calls out 3161LF Chain link fence removal but the scale is showing closer to 3475LF	Hank Amen	Drawing 53 of 53 has been replaced and is provided as Addendum 1 Attachment 3.This is a unit price Bid. The Measurement to Bid is 3161 LF. Adjustments (Adders of Deducts) will be in accordance with the Contract Documents..